

South Australia (CERTIFICATE OF TITLE)

No. 15



Register Book,

Vol. 2823 Folio 105

Balance Certificate of Title from Vol.1671 Folio 175

RAY HANNAFORD of Saddleworth Farmer and Agent

is the proprietor of an estate in fee simple subject nevertheless to such encumbrances liens and interests as are notified by memorial underwritten or endorsed hereon in THAT piece of land situate in the HUNDRED of SADDLEWORTH COUNTY of LIGHT being PORTION OF ALLOTMENTS 7, 8 and 9 of the subdivision of Section 411 laid out as SADDLEWORTH and more particularly delineated and bounded as appears in the plan in the margin hereof and therein colored green WHICH said Allotments are bounded as appears in the plan deposited in the Lands Titles Registration Office No.252

Which said Section is delineated in the public map of the said Hundred deposited in the Land Office at Adelaide.

Except such portion of the within land acquired by the Crown for road purposes

B. Nelson Hayken
Dep. Reg. Gen.

In witness whereof I have hereunto signed my name and affixed my seal this *twenty third* day of November 19 60

Signed the *23rd* day of November 19 60, in the presence of

M. Daly

[Signature]
Registrar-General.



Exam. vide Tr. 3305240
B. Nelson Hayken
Dep. Reg. Gen.

Abuttal vide Tr. 3046867
B. Nelson Hayken
Dep. Reg. Gen.

T/A 3122 861 T/3122 862

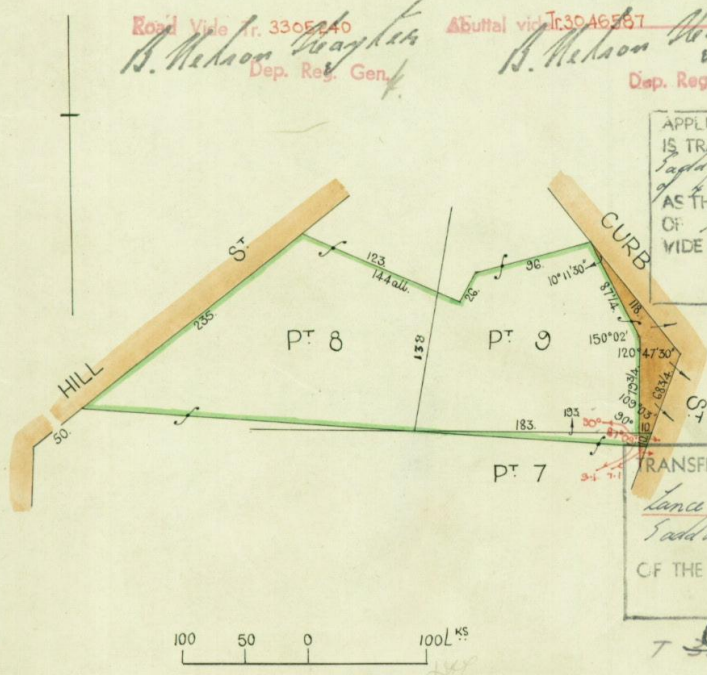

APPLICATION No. *3122861* THE WITHIN land IS TRANSMITTED TO *Ray Hannaford* of Saddleworth, Farmer and Agent of 45 Ruxie Avenue, Saddleworth, South Australia AS THE EXECUTOR NAMED IN THE WILL DATED *24-6-1882* of *Robert Marchmont* WHO DIED *1-10-47* WIFE PROBATE DATED *2-3-1970* PRODUCED *28-7-1970* AT *2.30 PM*
DEP. REG. GEN.

TRANSFER No. *3122862* to *Lance Malcolm Venter* of Saddleworth General Engineer OF THE WITHIN LAND, PRODUCED *28-7-1970* AT *2.30 PM*
J. Hughes.
DEP. REG. GEN.

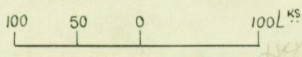

OVER

TRANSFER No. 3212986 *To*
Saddleworth District Historical
Society Incorporated of Saddleworth 5413
OF THE WITHIN LAND. PRODUCED 11.6.1971 AT 1.30pm
J. Hughes. DEP. REG. GEN.

T 32 of 240

TRANSFER No. 3305240. *To*
~~HER MAJESTY QUEEN ELIZABETH THE SECOND~~ *of portion*
part lot 7.
OF THE WITHIN LAND PRODUCED 10.4.1972 AT 11.20 AM.
J. Hughes. DEP. REG. GEN.

CANCELLED AS REGARDS LAND IN TRANSFER
No. 3305240 THE SAID LAND HAVING BEEN
ACQUIRED BY THE CROWN FOR ROAD PURPOSES.
J. Hughes. DEP. REG. GEN.

CANCELLED
CONVERTED TO A COMPUTERISED TITLE
